



"ZM KOLNO" S.A.

ul. Wojska Polskiego 56, 18-500 Kolno
tel.: +48 86 27 82 722
+48 86 27 82 766
fax: +48 86 27 82 141
e-mail: zmkolno@zmkolno.pl
www.zmkolno.pl

DIN 69871



Page
Strona
15



Page
Strona
16



Page
Strona
17



Page
Strona
18



Page
Strona
19



Page
Strona
20

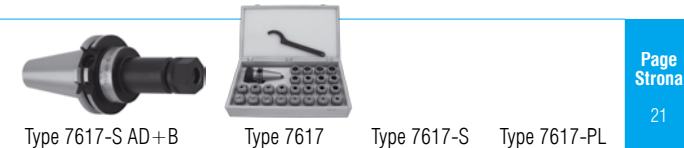

Page
Strona
21



Page
Strona
22



Page
Strona
23



Page
Strona
24



Page
Strona
25



Page
Strona
26

MAS 403-BT



Page
Strona
29



Page
Strona
30



Page
Strona
31

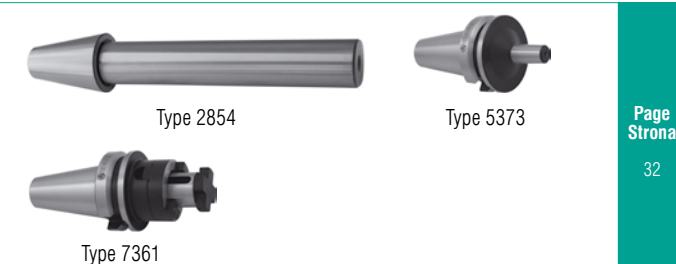

Page
Strona
32



Page
Strona
33



Page
Strona
34

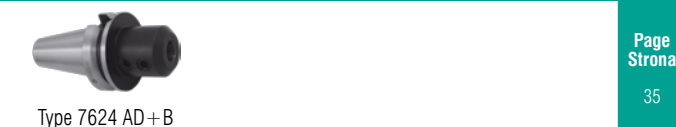

Page
Strona
35



Page
Strona
36

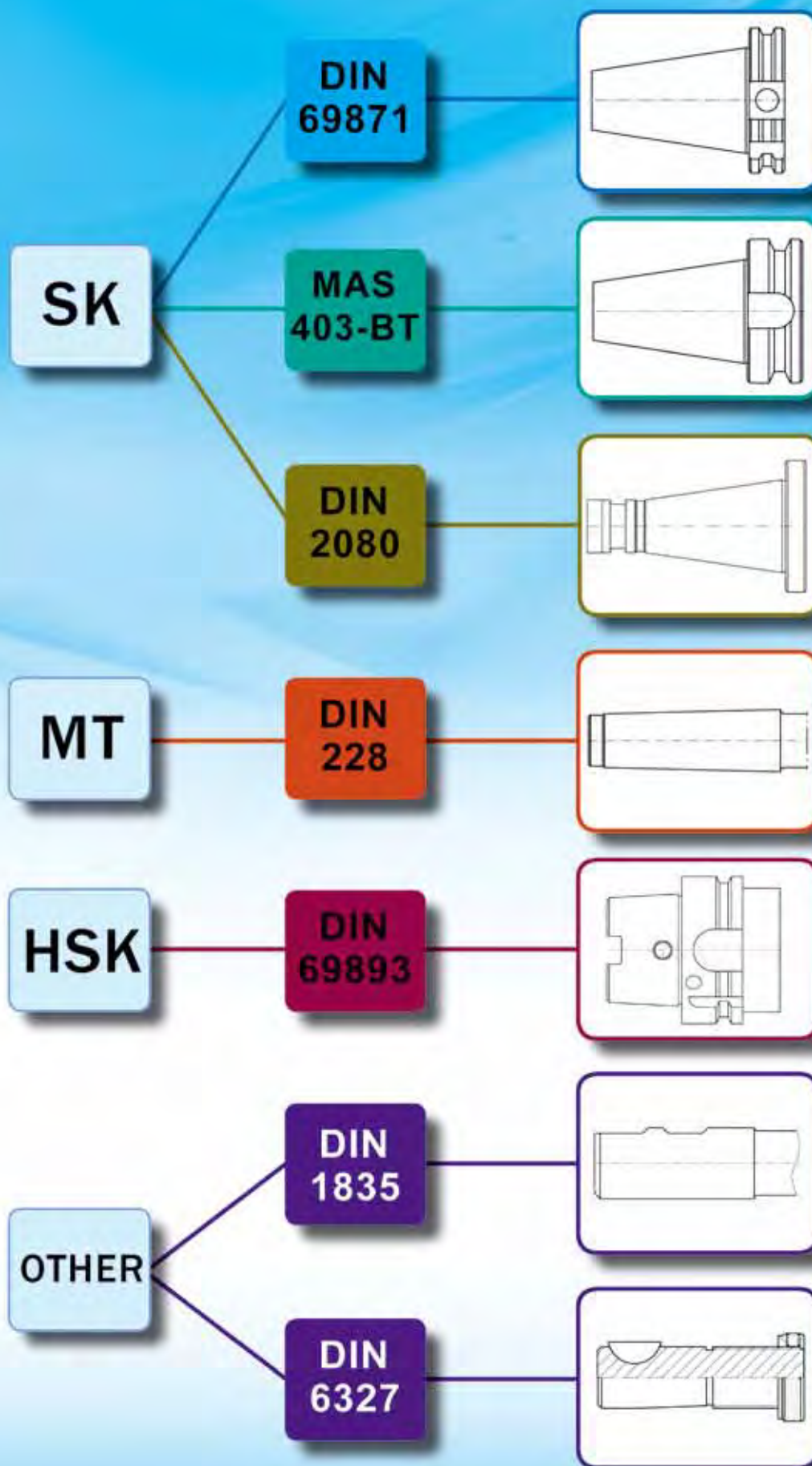



DIN 69871

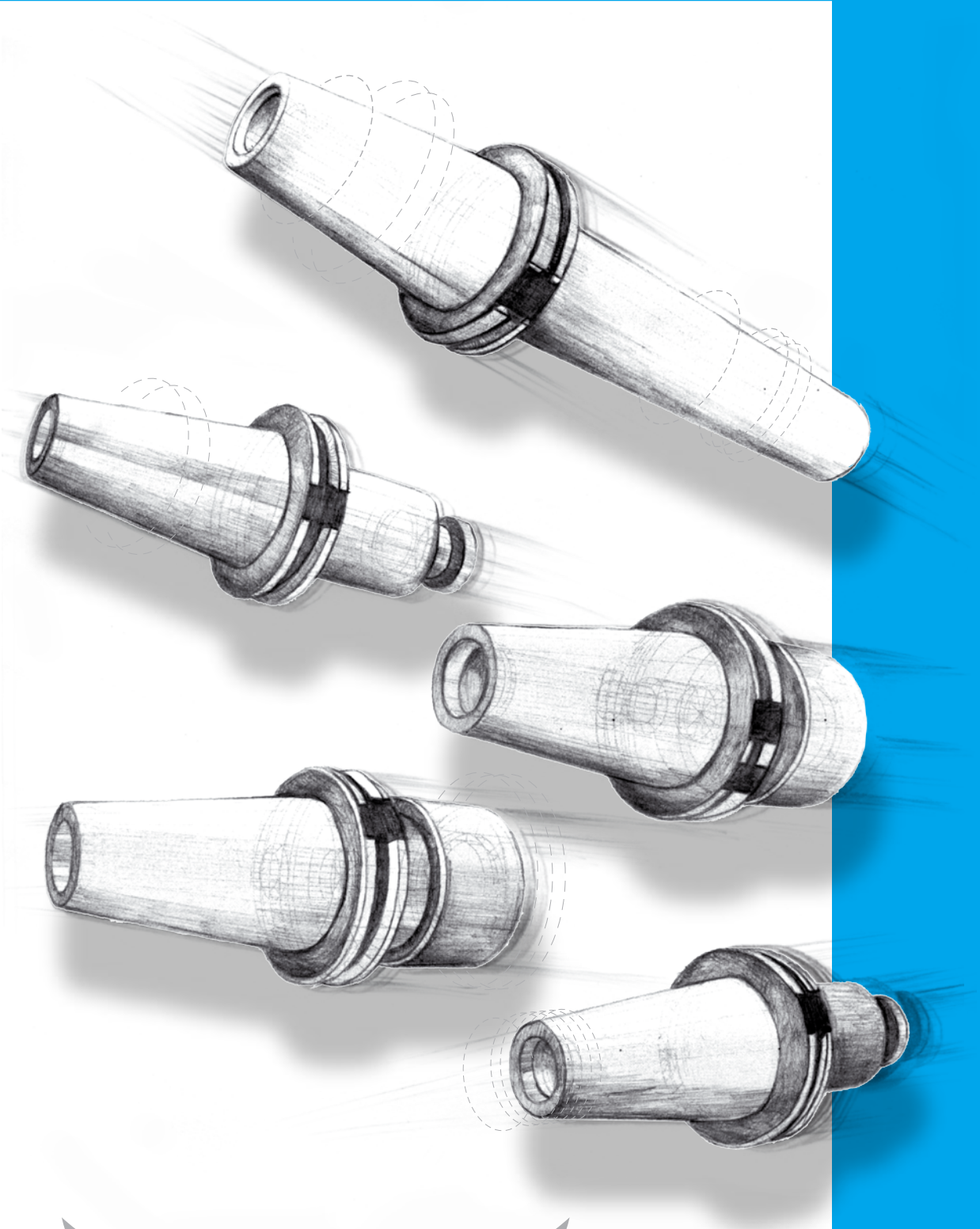

BISON BIAL

1

DIN 69871-A

TOOL SHANKS with 7:24 for automatic tool exchange

CHWYT ze stożkiem 7:24 do wymiany automatycznej

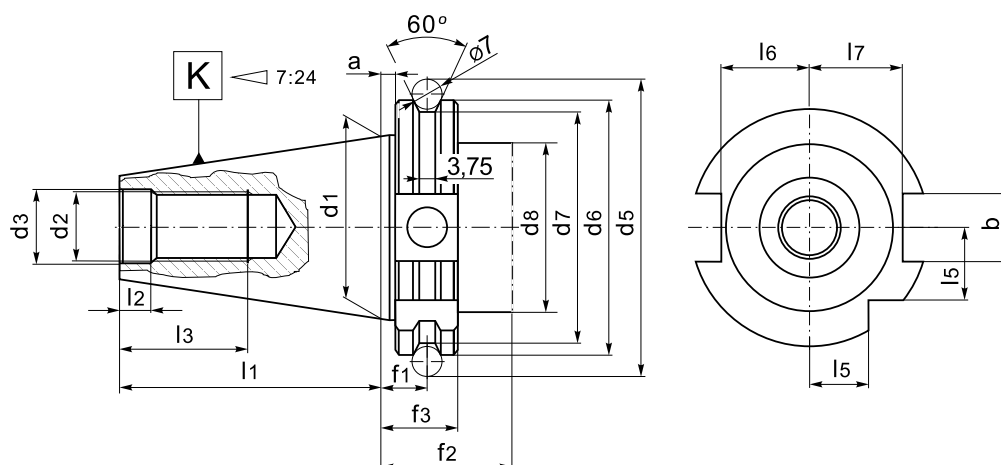

K 7:24	a	bH12	d1	d2	d3H7	d5	d6	d7	d8 _{max}
30	3,2	16,1	31,75	M12	13	59,30	50,00	44,30	45
40	3,2	16,1	44,45	M16	17	72,30	63,55	56,25	50
50	3,2	25,7	69,85	M24	25	107,25	97,50	91,25	80

K 7:24	f1	f2 _{min}	f3	I1	I2	I3	I5	I6	I7
30	11,1	35	19,1	47,80	5,5	24	15,0	16,4	19,0
40	11,1	35	19,1	68,40	8,2	32	18,5	22,8	25,0
50	11,1	35	19,1	101,75	11,5	47	30,0	35,5	37,7

STANDARD FEATURES OF TOOLING

- Manufactured with Chrome Manganese steel.
- Carburized with depth of case 0,7 mm.
- Hardened and precision ground.
- Surface Hardness RC 58±2.
- Taper angle: tolerance AT3.

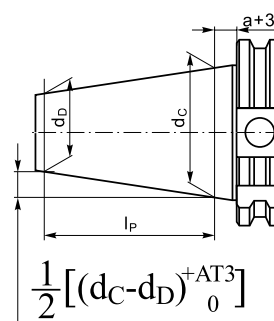

CHARAKTERYSTYKA TECHNICZNA WYROBÓW

- Materiał: stal stopowa chromowo-manganowa
- Nawęglane na głębokość 0,7 mm.
- Hartowane i precyzyjnie szlifowane.
- Twardość powierzchni 58±2 HRC.
- Tolerancja kąta stożka At3.

K 7:24	dC-dD	lp	a	AT3
30	12,250	42	3,2	0,002
40	17,208	59	3,2	0,003
50	26,833	92	3,2	0,004

Type 1606



HOLDERS for adjustable adapters DIN 6327

OPRAWKI do trzpieni i tulei z regulacją osiową DIN 6327

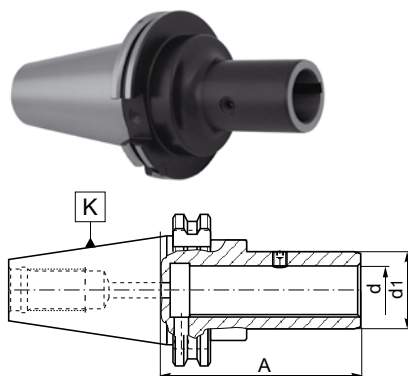

DIN 69871-AD

Code No / Kod Nr	K 7:24	d	d1	A	
0642 116 060 404	40	16	25	75	U-1997/0
0642 116 060 506		20	32	80	U-1997/0
0642 116 060 608		28	40	100	U-7381/0
0642 116 060 700		36	50	115	U-7381/0
0642 116 060 801	50	16	25	85	U-1997/0
0642 116 060 903		20	32	85	U-1997/0
0642 116 061 008		28	40	100	U-7381/0
0642 116 061 100		36	50	100	U-7381/0
0642 116 061 201		48	67	105	U-7382/0

Typical order/Sposób zamawiania: 0642 116 060 506 lub 1606-40-20-80

Type 1681



REDUCING ADAPTERS for tools with Morse taper and tang DIN 228-B shank or for tools with Morse taper shank and drawbar thread DIN 228-A

TULEJE REDUKCYJNE do narzędzi z chwytem Morse'a z płetwą wg DIN 228-B lub do narzędzi z chwytem Morse'a z gwintem wg DIN 228-A

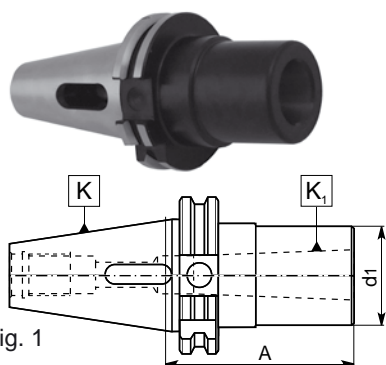

Fig. 1

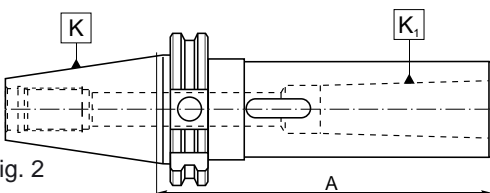

Fig. 2

DIN 69871-AD

Code No / Kod Nr	K 7:24	K1 Morse	A	d1	Fig.
0642 116 810 119	30	1	50	25	1
0642 116 810 210		2*	60	32	1
0642 116 810 312		3*	80	40	1
0642 116 810 106	40	1	50	25	1
0642 116 810 208		2	50	32	1
0642 116 810 300		3*	70	40	1
0642 116 810 401		4*	95	48	1
0642 116 810 503		1	120	25	2
0642 116 810 605		2	120	32	2
0642 116 810 707		3*	135	40	2
0642 116 810 809		4*	165	48	2
0642 116 811 107	50	1	45	25	1
0642 116 811 209		2	60	32	1
0642 116 811 300		3	65	40	1
0642 116 811 402		4	95	48	1
0642 116 811 504		5*	105	63	1
0642 116 811 606		1	120	25	2
0642 116 811 708		2	135	32	2
0642 116 811 800		3	155	40	2
0642 116 811 901		4	180	48	2
0642 116 812 108		5*	215	63	2

Typical order/Sposób zamawiania: 0642 116 811 300 lub 1681-50-3-65

* only for tools with Morse taper and tang DIN 228-B shank

* tylko do narzędzi z chwytem Morse'a z płetwą wg DIN 228-B

Type 1681 AD+B



REDUCING ADAPTERS for tools with Morse taper and tang DIN 228-B shank or for tools with Morse taper shank and drawbar thread DIN 228-A

TULEJE REDUKCYJNE do narzędzi z chwytem Morse'a z płetwą wg DIN 228-B lub do narzędzi z chwytem Morse'a z gwintem wg DIN 228-A

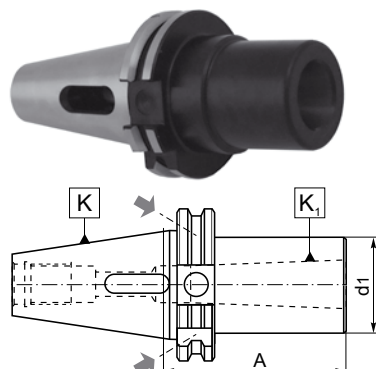

DIN 69871-AD+B

Code No / Kod Nr	K 7:24	K1 Morse	A	d1
0642 116 818 307	40	2	50	32
0642 116 818 409		3*	70	40
0642 116 818 500		4*	95	48
0642 116 819 308	50	2	60	32
0642 116 819 400		3	65	40
0642 116 819 501		4	95	48
0642 116 819 603		5*	120	63

Typical order/Sposób zamawiania: 0642 116 819 603 lub 1681-50-5-120 AD+B

* only for tools with Morse taper and tang DIN 228-B shank

* tylko do narzędzi z chwytem Morse'a z płetwą wg DIN 228-B

Type 1682



REDUCING ADAPTERS for tools with Morse taper shank and drawbar thread DIN 228-A

TULEJE REDUKCYJNE do narzędzi z chwytem Morse'a z gwintem wg DIN 228-A

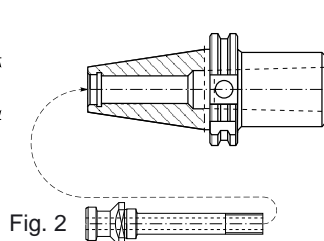
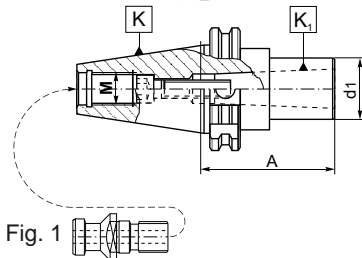

DIN 69871-A

Code No / Kod Nr	K 7:24	K1 Morse	A	d1	M	fig.	
0642 116 820 104	40	1	45	25	M16	1	W-1091/0
0642 116 820 206		2	60	32	M16	1	W-1092/0
0642 116 820 308		3	75	40	—	2	—
0642 116 820 400		4	85	48	—	2	—
0642 116 821 105	50	1	45	25	M24	1	W-1091/0
0642 116 821 207		2	45	32	M24	1	W-1095/0
0642 116 821 309		3	60	40	M24	1	W-1096/0
0642 116 821 400		4	75	48	M24	1	U-5984/0
0642 116 821 502		5	75	63	—	2	—

Typical order/Sposób zamawiania: 0642 116 821 502 lub 1682-50-5-75

Type 1684



TAPER ADAPTERS for tools with 7:24 taper shank

TULEJE REDUKCYJNE do narzędzi z chwytem 7:24

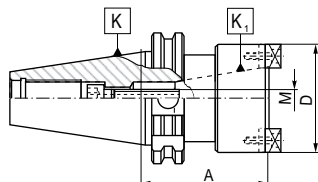

DIN 69871-AD

Code No / Kod Nr	K 7:24	K1 7:24	A	D	M	
0642 116 840 508	50	40	80	88	M16	U-6227/0

Typical order/Sposób zamawiania: 0642 116 840 508 lub 1684-50-40-80

Type 1695



REDUCING ADAPTERS for tools with Morse taper shank and drawbar thread DIN 228-A

TULEJE REDUKCYJNE do narzędzi z chwytem Morse'a z gwintem wg DIN 228-A

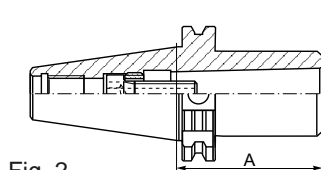
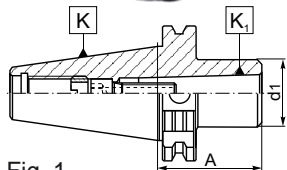

DIN 69871-AD

Code No / Kod Nr	K 7:24	K1 Morse	A	d1	Fig.	
0642 116 952 108	30	1	50	25	1	W-1091/0
0642 116 952 200		2	60	32	2	W-1095/0
0642 116 952 301		3	85	40	2	U-7790/0
0642 116 950 106	40	1	50	25	1	W-1091/0
0642 116 950 208		2	50	32	1	W-1092/0
0642 116 950 300		3	70	40	2	W-1093/0
0642 116 950 401		4	95	48	2	W-1094/0
0642 116 951 107	50	1	45	25	1	W-1091/0
0642 116 951 209		2	60	32	1	W-1095/0
0642 116 951 300		3	65	40	1	W-1096/0
0642 116 951 402		4	95	48	1	W-1097/0
0642 116 951 504		5	120	63	2	W-1098/0

Typical order/Sposób zamawiania: 0642 116 951 504 lub 1695-50-5-120

Type 1695 AD+B



REDUCING ADAPTERS for tools with Morse taper shank and drawbar thread DIN 228-A

TULEJE REDUKCYJNE do narzędzi z chwytem Morse'a z gwintem wg DIN 228-A

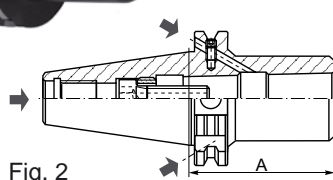
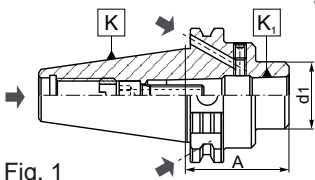

DIN 69871-AD+B

Code No / Kod Nr	K 7:24	K1 Morse	A	d1	Fig.	
0642 116 955 304	40	2	50	32	1	W-1092/0
0642 116 955 406		3	70	40	2	W-1093/0
0642 116 955 508		4	95	48	2	W-1094/0
0642 116 956 305	50	2	60	32	1	W-1095/0
0642 116 956 407		3	65	40	1	W-1096/0
0642 116 956 509		4	95	48	1	W-1097/0
0642 116 956 600		5	120	63	2	W-1098/0

Typical order/Sposób zamawiania: 0642 116 956 600 lub 1695-50-5-120 AD+B

Type 2191

BALANCE
on request

BLANK ADAPTERS

TRZPIEŃ - PÓŁFABRYKAT

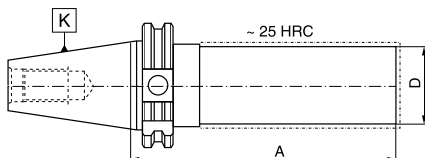

DIN 69871-A

Code No / Kod Nr	K 7:24	D	A
0642 121 910 107	40	40	250
0642 121 910 209		40	280
0642 121 910 313		63	160
0642 121 910 110		63	250
0642 121 910 300		63	280
0642 121 910 402		80	270
0642 121 911 200	50	50	330
0642 121 911 238		63	250
0642 121 911 266		63	315
0642 121 911 301		80	330
0642 121 911 403		95	250
0642 121 911 431		97	250
0642 121 911 460		97	315

Typical order/Sposób zamawiania: 0642 121 911 301 lub 2191-50-80-330

Type 2827

BALANCE
on request

ADAPTERS for indexable milling cutters

TRZPIENIE FREZARSKIE do głowic frezarskich

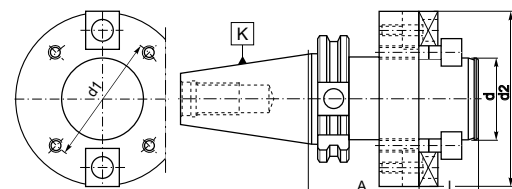

DIN 69871-A

Code No / Kod Nr	K 7:24	d	d1	d2	A	I		
0642 128 270 100	40	40	66,7	89	60	30	U-6064/0	U-1414/0
0642 128 270 008		60	101,6	129	60	40	U-6066/0	U-2042/0
0642 128 270 201	50	40	66,7	89	70	30	U-6064/0	U-1414/0
0642 128 270 303		60	101,6	129	70	40	U-6066/0	U-2042/0

Typical order/Sposób zamawiania: 0642 128 270 303 lub 2827-50-60

Type 2852

TEST ARBORS

TRZPIENIE KONTROLNE

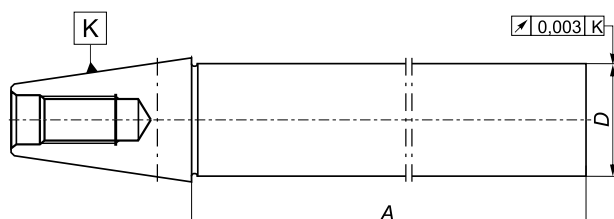

DIN 69871-A

Code No / Kod Nr	K 7:24	D	A
0642128 521 000	40	40	300
0642 128 522 000	50	50	300

Typical order/Sposób zamawiania: 0642 128 521 000 lub 2852-40-40-300

Type 5374



DRILL CHUCK ADAPTERS for drill chucks taper DIN 238 or Jacobs taper
TRZPIENIE do uchwytów wiertarskich ze stożkiem DIN 238 lub Jacobsa

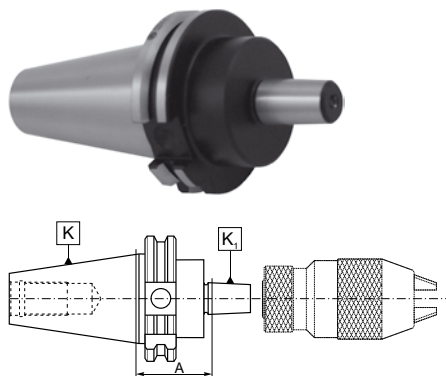

DIN 69871-A

Code No / Kod Nr	K 7:24	K1 DIN/Jacobs	A
0642 153 742 200	30	B12	25
0642 153 742 301		B16	25
0642 153 740 106	40	B12	40
0642 153 740 605		B12	90
0642 153 740 300		B16	40
0642 153 740 707		B16	90
0642 153 740 503		B18	40
0642 153 740 809		B18	90
0642 153 741 300	50	B16	40
0642 153 741 504		B16	90
0642 153 741 402		B18	40
0642 153 741 606		B18	90
0642 153 745 202	40	J33	40
0642 153 745 600		J6	40
0642 153 746 203	50	J33	40
0642 153 746 600		J6	40

Typical order/Sposób zamawiania: 0642 153 741 606 lub 5374-50-B18-90

Type 7301



COMBINATION SHELL MILL ADAPTERS for cutters with keyway
or driving slot DIN 138

TRZPIENIE FREZARSKIE UNIWERSALNE do frezów z rowkiem wpustowym lub rowkiem zabierakowym w/g DIN 138

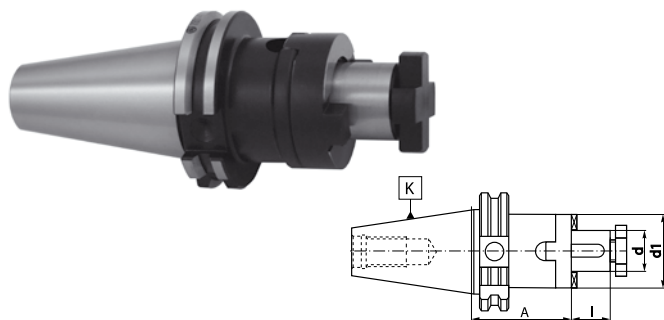

DIN 69871-A

Code No / Kod Nr	K 7:24	d	A	L	d1			
0642 173 010 000	40	16	55	17	32	U-0620/0	U-1364/0	U-1355/0
0642 173 010 101		22	55	19	40	U-0621/0	U-1365/0	U-1356/0
0642 173 010 203		27	55	21	48	U-0622/0	U-1366/0	U-1357/0
0642 173 010 305		32	60	24	58	U-0623/0	U-1367/0	U-6355/0
0642 173 010 407		40	60	27	70	U-0624/0	U-1368/0	U-1359/0
0642 173 010 509	50	16	55	17	32	U-0620/0	U-1364/0	U-1355/0
0642 173 010 600		22	55	19	40	U-0621/0	U-1365/0	U-1356/0
0642 173 010 702		27	55	21	48	U-0622/0	U-1366/0	U-1357/0
0642 173 010 804		32	55	24	58	U-0623/0	U-1367/0	U-6355/0
0642 173 010 906		40	55	27	70	U-0624/0	U-1368/0	U-1359/0
0642 173 011 102		50	70	30	90	U-0625/0	U-1369/0	U-1360/0

Typical order/Sposób zamawiania: 0642 173 010 600 lub 7301-50-22-55

Type 7369



SHELL MILL ADAPTERS for cutters with driving slot DIN 138

TRZPIENIE FREZARSKIE ZABIERAKOWE do frezów z rowkiem zabierakowym w/g DIN 138

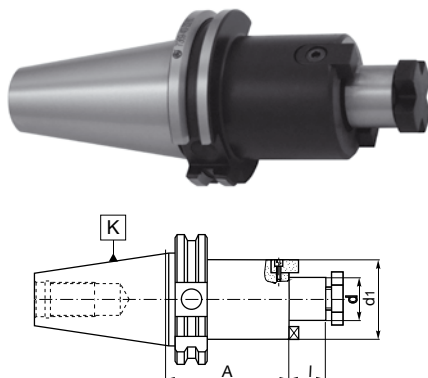

DIN 69871-A

Code No / Kod Nr	K 7:24	d	A	L	d1		
0642 173 693 205	30	16	35	17	32	U-0620/0	S-2117/0
0642 173 693 307		22	35	19	40	U-0621/0	S-2121/0
0642 173 693 409		27	60	21	48	U-0622/0	S-2111/0
0642 173 693 500		32	60	24	58	U-0623/0	S-2114/0
0642 173 690 100	40	16	60	17	32	U-0620/0	S-2117/0
0642 173 690 600		16	120	17	32	U-0620/0	S-2117/0
0642 173 690 202		22	60	19	40	U-0621/0	S-2121/0
0642 173 690 701		22	120	19	40	U-0621/0	S-2121/0
0642 173 690 304		27	60	21	48	U-0622/0	S-2111/0
0642 173 690 803		27	120	21	48	U-0622/0	S-2111/0
0642 173 690 406		32	60	24	58	U-0623/0	S-2114/0
0642 173 690 905		32	120	24	58	U-0623/0	S-2114/0
0642 173 690 508		40	60	27	70	U-0624/0	S-2124/0
0642 173 691 101	50	16	60	17	32	U-0620/0	S-2117/0
0642 173 691 702		16	110	17	32	U-0620/0	S-2117/0
0642 173 691 203		22	60	19	40	U-0621/0	S-2121/0
0642 173 691 804		22	110	19	40	U-0621/0	S-2121/0
0642 173 691 305		27	60	21	48	U-0622/0	S-2111/0
0642 173 691 906		27	110	21	48	U-0622/0	S-2111/0
0642 173 691 407		32	60	24	58	U-0623/0	S-2114/0
0642 173 692 102		32	110	24	58	U-0623/0	S-2114/0
0642 173 691 509		40	60	27	70	U-0624/0	S-2124/0
0642 173 692 204		40	110	27	70	U-0624/0	S-2124/0
0642 173 691 600		50	60	30	90	U-0625/0	U-5974/0

Typical order/Sposób zamawiania: 0642 173 010 600 lub 7301-50-22-55

Type 7369 AD+B



SHELL MILL ADAPTERS for cutters with driving slot DIN 138
TRZPIENIE FREZARSKIE ZABIERAKOWE do frezów z rowkiem zabierakowym w/g DIN 138

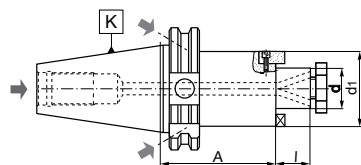

DIN 69871-AD+B

1

Code No / Kod Nr	K 7:24	d	A	L	d1		
0642 173 695 105	40	16	45	17	38	U-0620/0	W-1945/0
0642 173 695 120		16	100	17	38	U-0620/0	W-1945/0
0642 173 695 146		16	130	17	38	U-0620/0	W-1945/0
0642 173 695 161		16	160	17	38	U-0620/0	W-1945/0
0642 173 695 207		22	45	19	48	U-0621/0	W-1946/0
0642 173 695 222		22	100	19	48	U-0621/0	W-1946/0
0642 173 695 248		22	130	19	48	U-0621/0	W-1946/0
0642 173 695 263		22	160	19	48	U-0621/0	W-1946/0
0642 173 695 309		27	60	21	58	U-0622/0	W-1947/0
0642 173 695 324		27	100	21	58	U-0622/0	W-1947/0
0642 173 695 340		27	130	21	58	U-0622/0	W-1947/0
0642 173 695 365		27	160	21	58	U-0622/0	W-1947/0
0642 173 695 400		32	60	24	66	U-0623/0	W-1948/0
0642 173 695 426		32	100	24	66	U-0623/0	W-1948/0
0642 173 695 441		32	130	24	66	U-0623/0	W-1948/0
0642 173 695 467		32	160	24	66	U-0623/0	W-1948/0
0642 173 695 502		40	65	27	80	U-0624/0	W-1949/0
0642 173 695 528		40	100	27	80	U-0624/0	W-1949/0
0642 173 695 543		40	130	27	80	U-0624/0	W-1949/0
0642 173 695 569		40	160	27	80	U-0624/0	W-1949/0
0642 173 696 208	50	16	50	17	38	U-0620/0	W-1945/0
0642 173 696 223		16	100	17	38	U-0620/0	W-1945/0
0642 173 696 249		16	130	17	38	U-0620/0	W-1945/0
0642 173 696 264		16	160	17	38	U-0620/0	W-1945/0
0642 173 696 280		16	200	17	38	U-0620/0	W-1945/0
0642 173 696 300		22	50	19	48	U-0621/0	W-1946/0
0642 173 696 325		22	100	19	48	U-0621/0	W-1946/0
0642 173 696 340		22	130	19	48	U-0621/0	W-1946/0
0642 173 696 366		22	160	19	48	U-0621/0	W-1946/0
0642 173 696 381		22	200	19	48	U-0621/0	W-1946/0
0642 173 696 401		27	55	21	58	U-0622/0	W-1947/0
0642 173 696 427		27	100	21	58	U-0622/0	W-1947/0
0642 173 696 442		27	130	21	58	U-0622/0	W-1947/0
0642 173 696 468		27	160	21	58	U-0622/0	W-1947/0
0642 173 696 483		27	200	21	58	U-0622/0	W-1947/0
0642 173 696 503		32	60	24	66	U-0623/0	W-1948/0
0642 173 696 529		32	100	24	66	U-0623/0	W-1948/0
0642 173 696 544		32	130	24	66	U-0623/0	W-1948/0
0642 173 696 560		32	160	24	66	U-0623/0	W-1948/0
0642 173 696 585		32	200	24	66	U-0623/0	W-1948/0
0642 173 696 605		40	65	27	80	U-0624/0	W-1949/0
0642 173 696 620		40	100	27	80	U-0624/0	W-1949/0
0642 173 696 646		40	130	27	80	U-0624/0	W-1949/0
0642 173 696 661		40	160	27	80	U-0624/0	W-1949/0
0642 173 696 687		40	200	27	80	U-0624/0	W-1949/0
0642 173 696 707		50	70	30	90	U-0625/0	U-5974/0
0642 173 696 722		50	100	30	90	U-0625/0	U-5974/0
0642 173 696 748		50	130	30	90	U-0625/0	U-5974/0
0642 173 696 763		50	160	30	90	U-0625/0	U-5974/0
0642 173 696 789		50	200	30	90	U-0625/0	U-5974/0

Typical order/Sposób zamawiania: 0642 173 695 105 lub 7369-40-16-45 AD+B

Type 7373



MILLING ARBORS for staggered tooth side milling cutters
TRZPIENIE FREZARSKIE do frezów tarczowych

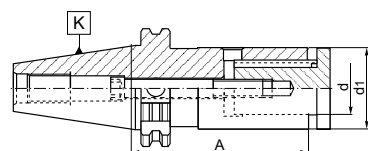

DIN 69871-A

Code No / Kod Nr	K 7:24	d	d1	A	Capacity/ Zakres			
0642 173 731 008	40	16	29	95	0-10	U-6520/0	U-6510/0	U-6526/0
0642 173 731 100		16	29	125	0-16	U-6520/0	U-6511/0	U-6527/0
0642 173 731 201		22	36	95	0-10	U-6523/0	U-6512/0	U-6528/0
0642 173 731 303		22	36	125	0-20	U-6523/0	U-6513/0	U-6529/0
0642 173 731 405		27	42	95	0-10	U-6523/0	U-6514/0	U-6530/0
0642 173 731 507		27	42	125	0-20	U-6523/0	U-6515/0	U-6531/0
0642 173 731 609		32	50	95	0-10	U-6523/0	U-6516/0	U-6532/0
0642 173 731 700		32	50	125	0-20	U-6523/0	U-6517/0	U-6533/0
0642 173 732 009	50	22	36	100	0-10	U-6524/0	U-6512/0	U-6528/0
0642 173 732 100		22	36	125	0-20	U-6524/0	U-6513/0	U-6529/0
0642 173 732 202		27	42	100	0-10	U-6524/0	U-6514/0	U-6530/0
0642 173 732 304		27	42	125	0-20	U-6524/0	U-6515/0	U-6531/0
0642 173 732 406		32	50	100	0-10	U-6524/0	U-6516/0	U-6532/0
0642 173 732 508		32	50	125	0-20	U-6524/0	U-6517/0	U-6533/0
0642 173 732 600		40	58	100	0-10	U-6524/0	U-6518/0	U-6534/0
0642 173 732 701		40	58	125	0-20	U-6524/0	U-6519/0	U-6535/0

Typical order/Sposób zamawiania: 0642 173 731 405 lub 7373-40-27-95

Type 7617



COLLET CHUCKS ER for tool with cylindrical shank

OPRAWKI ZACISKOWE (do tulejek ER DIN 6499) do narzędzi z chwytem walcowym

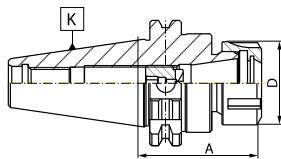

Standard accessories:

Nut - page 121
screw

Wyposażenie podstawowe:

Nakrętka - str. 121
wkreć

Optional accessories:

Collets - page 107
wrench - page 121

Wyposażenie dodatkowe:

Tulejki zaciskowe - str. 107
klucz - str. 121

DIN 69871-AD

Code No / Kod Nr	K 7:24	Collet Tulejka	A	Capacity Zakres	D		
0642 176 170 621	30	ER16	60	2-10	32	9833-16	M10x11LH
0642 176 170 690		ER25	60	2-16	42	9833-25	M18x1,5x19LH
0642 176 170 647		ER32	60	2-20	50	9833-32	M18x1,5x19LH
0642 176 170 265	40	ER16	60	2-10	32	9833-16	M12x1,5x14LH
0642 176 170 005		ER25	60	2-16	42	9833-25	M18x1,5x19LH
0642 176 170 240		ER25	130	2-16	42	9833-25	M18x1,5x19LH
0642 176 170 300		ER32	70	2-20	50	9833-32	M22x1,5x24LH
0642 176 171 301		ER32	130	2-20	50	9833-32	M22x1,5x24LH
0642 176 170 901		ER40	70	2-26	63	9833-40	M28x1,5x30LH
0642 176 171 709	50	ER32	70	2-20	50	9833-32	M22x1,5x24LH
0642 176 172 007		ER32	130	2-20	50	9833-32	M22x1,5x24LH
0642 176 172 302		ER40	80	2-26	63	9833-40	M28x1,5x30LH
0642 176 172 700		ER40	130	2-26	63	9833-40	M28x1,5x30LH

Typical order/Sposób zamawiania: 0642 176 172 700 lub 7617-50-40-130

Type 7617 AD+B



COLLET CHUCKS ER for tool with cylindrical shank

OPRAWKI ZACISKOWE (do tulejek ER DIN 6499) do narzędzi z chwytem walcowym

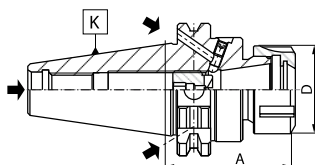

Standard accessories:

Nut - page 121
screw

Wyposażenie podstawowe:

Nakrętka - str. 121
wkreć

Optional accessories:

Collets - page 107
wrench - page 121

Wyposażenie dodatkowe:

Tulejki zaciskowe - str. 107
klucz - str. 121

DIN 69871-AD+B

Code No / Kod Nr	K 7:24	Collet Tulejka	A	Capacity Zakres	D		
0642 176 176 347	40	ER16	60	2-10	32	9833-16	M12x1,5x14LH
0642 176 176 464		ER25	60	2-16	42	9833-25	M18x1,5x19LH
0642 176 176 477		ER25	130	2-16	42	9833-25	M18x1,5x19LH
0642 176 176 500		ER32	70	2-20	50	9833-32	M22x1,5x24LH
0642 176 176 540		ER32	160	2-20	50	9833-32	M22x1,5x24LH
0642 176 176 566		ER40	70	2-26	63	9833-40	M28x1,5x30LH
0642 176 176 668	50	ER32	70	2-20	50	9833-32	M22x1,5x24LH
0642 176 176 744		ER32	160	2-20	50	9833-32	M22x1,5x24LH
0642 176 176 785		ER40	80	2-26	63	9833-40	M28x1,5x30LH
0642 176 176 820		ER40	160	2-26	63	9833-40	M28x1,5x30LH

Typical order/Sposób zamawiania: 0642 176 172 700 lub 7617-50-40-130

Type 7617-S



COLLET CHUCKS ER for tool with cylindrical shank

OPRAWKI ZACISKOWE (do tulejek ER DIN 6499) do narzędzi z chwytem walcowym

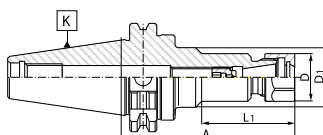

Standard accessories:

Nut - page 121
screw

Wyposażenie podstawowe:

Nakrętka - str. 121
wkreć

Optional accessories:

Collets - page 107
wrench - page 121

Wyposażenie dodatkowe:

Tulejki zaciskowe - str. 107
klucz - str. 121

DIN 69871-AD

Code No / Kod Nr	K 7:24	Collet Tulejka	A	Capacity Zakres	L1	D	D1		
0642 176 174 126	40	ER16	100	2-10	-	28	-	9833-16D	M12x1,5x14LH
0642 176 174 228		ER16	150	2-10	85	28	40	9833-16D	M12x1,5x14LH
0642 176 174 523	50	ER16	100	2-10	-	28	-	9833-16D	M12x1,5x14LH
0642 176 174 625		ER16	150	2-10	85	28	40	9833-16D	M12x1,5x14LH

Typical order/Sposób zamawiania: 0642 176 174 625 lub 7617-50-16-150 S

Type 7617-S



COLLET CHUCKS ER for tool with cylindrical shank

OPRAWKI ZACISKOWE (do tulejek ER DIN 6499) do narzędzi z chwytem walcowym

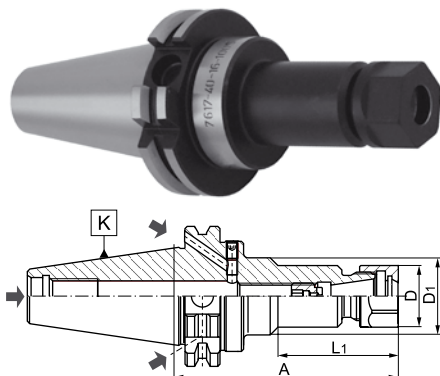

DIN 69871-AD+B

Code No / Kod Nr	K 7:24	Collet Tulejka	A	Capacity Zakres	L1	D	D1		
0642 176 176 388	40	ER16	100	2-10	—	28	—	9833-16D	M12x1,5x14LH
0642 176 176 423		ER16	160	2-10	86	28	40	9833-16D	M12x1,5x14LH
0642 176 176 581	50	ER16	100	2-10	—	28	—	9833-16D	M12x1,5x14LH
0642 176 176 627		ER16	160	2-10	86	28	40	9833-16D	M12x1,5x14LH

Typical order/Sposób zamawiania: 0642 176 176 627 lub 7617-50-16-160 S AD+B

Standard accessories:

Nut - page 121
screw

Wyposażenie podstawowe:

Nakrętka - str. 121
wkreś

Optional accessories:

Collets - page 107
wrench - page 121

Wyposażenie dodatkowe:

Tulejki zaciskowe - str. 107
klucz - str. 121

Type 7617



COLLET CHUCKS ER - SET for tool with cylindrical shank

OPRAWKI ZACISKOWE ER - KOMPLET do narzędzi z chwytem walcowym



DIN 69871-AD

Code No / Kod Nr	K 7:24	Collet Tulejka	A	Capacity Zakres	Full set pieces Ilość tulejek
0642 176 170 619	30	ER16	60	2-10	8
0642 176 170 634		ER32	60	2-20	18
0642 176 170 107	40	ER25	60	2-16	14
0642 176 170 402		ER32	70	2-20	18
0642 176 171 108		ER32	130	2-20	18
0642 176 170 708		ER40	70	2-26	24
0642 176 171 505	50	ER32	70	2-20	18
0642 176 171 800		ER32	130	2-20	18
0642 176 172 109		ER40	80	2-26	24
0642 176 172 506		ER40	130	2-26	24

Type 7617-S

Code No / Kod Nr	K 7:24	Collet Tulejka	A	Capacity Zakres	Full set pieces Ilość tulejek
0642 176 174 100	40	ER16	100	2-10	8
0642 176 174 202		ER16	150	2-10	8
0642 176 174 508	50	ER16	100	2-10	8
0642 176 174 600		ER16	150	2-10	8

Type 7617-PL

Code No / Kod Nr	K 7:24	Collet Tulejka	A	Capacity Zakres	Full set pieces Ilość tulejek
0642 176 170 650	30	ER32	60	3-20	8
Tulejki Ø 4,5,6,8,10,12,16,20					
0642 176 170 428	40	ER32	70	3-20	8
Tulejki Ø 4,5,6,8,10,12,16,20					
0642 176 171 518	50	ER32	70	3-20	8
Tulejki Ø 4,5,6,8,10,12,16,20					

Type 7625



DIN 69871-AD

END MILL ADAPTERS for cutters with cylindrical shank and weldon flat DIN 1835-B

OPRAWKA ZACISKOWA do narzędzi z chwytem walcowym Weldon'a DIN 1835-B

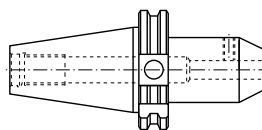

Fig. 1

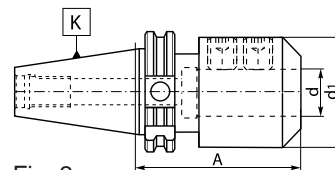

Fig. 2

Code No / Kod Nr	K 7:24	d	A	d1	Fig.	
0642 176 251 213	30	6	50	25,0	1	U-4131/0
0642 176 251 315		8	50	28,0	1	U-4132/0
0642 176 251 417		10	50	35,0	1	U-4133/0
0642 176 251 519		12	50	42,0	1	U-4134/0
0642 176 251 610		16	63	44,0	1	U-4135/0
0642 176 251 712		20	63	44,0	1	U-5888/0
0642 176 252 201	40	6	30	25,0	1	U-4131/0
0642 176 250 108		6	50	25,0	1	U-4131/0
0642 176 252 255		6	100	25,0	1	U-4131/0
0642 176 252 283		6	130	25,0	1	U-4131/0
0642 176 252 303		8	30	28,0	1	U-4132/0
0642 176 250 200		8	50	28,0	1	U-4132/0
0642 176 252 357		8	100	28,0	1	U-4132/0
0642 176 252 385		8	130	28,0	1	U-4132/0
0642 176 252 405		10	32	35,0	1	U-4133/0
0642 176 250 301		10	50	35,0	1	U-4133/0
0642 176 252 459		10	100	35,0	1	U-4133/0
0642 176 252 487		10	130	35,0	1	U-4133/0
0642 176 252 507		12	34	42,0	1	U-4134/0
0642 176 250 403		12	50	42,0	1	U-4134/0
0642 176 252 550		12	100	42,0	1	U-4134/0
0642 176 252 589		12	130	42,0	1	U-4134/0
0642 176 252 510		14	34	44,0	1	U-4134/0
0642 176 252 522		14	50	44,0	1	U-4134/0
0642 176 252 535		14	63	44,0	1	U-4134/0
0642 176 252 609		16	35	44,0	1	U-4135/0
0642 176 250 505		16	63	44,5	1	U-4135/0
0642 176 252 652		16	100	48,0	1	U-4135/0
0642 176 252 637		18	63	44,5	1	U-5887/0
0642 176 253 100		20	35	44,5	1	U-6756/0
0642 176 250 607		20	63	44,5	1	U-5888/0
0642 176 253 154		20	100	52,0	1	U-4136/0
0642 176 253 202		25	35	44,5	1	U-6756-0
0642 176 253 304		25	60	44,5	2	U-6756/0 U-6757/0
0642 176 250 709		25	100	63,0	2	U-4137/0 U-4137/0
0642 176 253 508		32	70	72,0	2	U-6755/0 U-4138/0
0642 176 250 800		32	100	72,0	2	U-4138/0 U-4138/0

Code No / Kod Nr	K 7:24	d	A	d1	Fig.	
0642 176 251 109	50	6	63	25,0	1	U-4131/0
0642 176 251 137		6	130	25,0	1	U-4131/0
0642 176 251 200		8	63	28,0	1	U-4132/0
0642 176 251 239		8	130	28,0	1	U-4132/0
0642 176 251 302		10	63	35,0	1	U-4133/0
0642 176 251 330		10	130	35,0	1	U-4133/0
0642 176 251 404		12	63	42,0	1	U-4134/0
0642 176 253 885		12	130	42,0	1	U-4134/0
0642 176 254 000		14	63	44,0	1	U-4134/0
0642 176 251 506		16	63	48,0	1	U-4135/0
0642 176 251 521		16	100	48,0	1	U-4135/0
0642 176 251 534		16	130	48,0	1	U-4135/0
0642 176 251 550		18	63	50,0	1	U-4135/0
0642 176 254 101		20	35	52,0	1	U-4136/0
0642 176 251 608		20	63	52,0	1	U-4136/0
0642 176 251 636		20	130	52,0	1	U-4136/0
0642 176 254 305		25	60	69,9	2	U-4136/0 U-4137/0
0642 176 251 700		25	80	65,0	2	U-4137/0 U-4137/0
0642 176 251 738		25	130	65,0	2	U-4137/0 U-4137/0
0642 176 254 509		32	70	69,9	2	U-4136/0 U-4138/0
0642 176 251 801		32	100	72,0	2	U-4138/0 U-4138/0
0642 176 251 830		32	130	72,0	2	U-4138/0 U-4138/0
0642 176 251 855		32	160	72,0	2	U-4138/0 U-4138/0
0642 176 251 896		40	100	80,0	2	U-5870/0 U-5870/0
0642 176 251 903		40	120	90,0	2	U-5870/0 U-5870/0
0642 176 252 100		50	130	100,0	2	U-4139/0 U-4139/0

Typical order/Sposób zamawiania: 0642 176 251 801 lub 7625-50-32-100

Type 7625

DIN 69871-AD+B
END MILL ADAPTERS for cutters with cylindrical shank and weldon flat DIN 1835-B

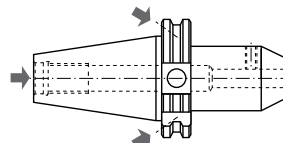
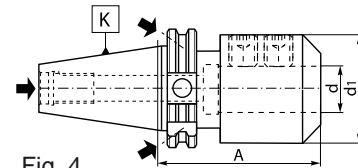
OPRAWKA ZACISKOWA do narzędzi z chwytem walcowym Weldon'a DIN 1835-B

Fig. 3

Fig. 4

Code No / Kod Nr	K 7:24	d	A	d1	Fig.	
0642 176 255 102	40	6	50	25,0	3	U-4131/0
0642 176 255 128		6	100	25,0	3	U-4131/0
0642 176 255 143		6	130	25,0	3	U-4131/0
0642 176 255 169		6	160	25,0	3	U-4131/0
0642 176 255 184		6	200	25,0	3	U-4131/0
0642 176 255 204		8	50	28,0	3	U-4132/0
0642 176 255 220		8	100	28,0	3	U-4132/0
0642 176 255 245		8	130	28,0	3	U-4132/0
0642 176 255 260		8	160	28,0	3	U-4132/0
0642 176 255 286		8	200	28,0	3	U-4132/0
0642 176 255 306		10	60	35,0	3	U-4133/0
0642 176 255 321		10	100	35,0	3	U-4133/0
0642 176 255 347		10	130	35,0	3	U-4133/0
0642 176 255 362		10	160	35,0	3	U-4133/0
0642 176 255 388		10	200	35,0	3	U-4133/0
0642 176 255 408		12	60	42,0	3	U-4134/0
0642 176 255 410		12	100	42,0	3	U-4134/0
0642 176 255 423		12	130	42,0	3	U-4134/0
0642 176 255 436		12	160	42,0	3	U-4134/0
0642 176 255 449		12	200	42,0	3	U-4134/0
0642 176 255 451		14	60	44,0	3	U-4134/0
0642 176 255 464		14	100	44,0	3	U-4134/0
0642 176 255 477		14	130	44,0	3	U-4134/0
0642 176 255 480		14	160	44,0	3	U-4134/0
0642 176 255 492		14	200	44,0	3	U-4134/0
0642 176 255 500		16	63	44,5	3	U-4135/0
0642 176 255 512		16	100	48,0	3	U-4135/0
0642 176 255 525		16	130	48,0	3	U-4135/0
0642 176 255 538		16	160	48,0	3	U-4135/0
0642 176 255 540		16	200	48,0	3	U-4135/0
0642 176 255 553		18	63	49,5	3	U-4135/0
0642 176 255 566		18	100	49,5	3	U-4135/0
0642 176 255 579		18	130	49,5	3	U-4135/0
0642 176 255 581		18	160	49,5	3	U-4135/0
0642 176 255 594		18	200	49,5	3	U-4135/0
0642 176 255 601		20	63	49,5	3	U-4136/0
0642 176 255 627		20	100	49,5	3	U-4136/0
0642 176 255 642		20	130	49,5	3	U-4136/0
0642 176 255 668		20	160	49,5	3	U-4136/0
0642 176 255 683		20	200	49,5	3	U-4136/0
0642 176 255 703		25	100	63,0	4	U-4137/0 U-4137/0
0642 176 255 729		25	130	65,0	4	U-4137/0 U-4137/0
0642 176 255 744		25	160	65,0	4	U-4137/0 U-4137/0
0642 176 255 760		25	200	65,0	4	U-4137/0 U-4137/0
0642 176 255 805		32	100	72,0	4	U-4138/0 U-4138/0
0642 176 255 818		32	130	72,0	4	U-4138/0 U-4138/0
0642 176 255 820		32	160	72,0	4	U-4138/0 U-4138/0
0642 176 255 833		32	200	72,0	4	U-4138/0 U-4138/0

Code No / Kod Nr	K 7:24	d	A	d1	Fig.	
0642 176 256 103	50	6	63	25,0	3	U-4131/0
0642 176 256 129		6	100	25,0	3	U-4131/0
0642 176 256 144		6	130	25,0	3	U-4131/0
0642 176 256 160		6	160	25,0	3	U-4131/0
0642 176 256 185		6	200	25,0	3	U-4131/0
0642 176 256 205		8	63	28,0	3	U-4132/0
0642 176 256 205		8	100	28,0	3	U-4132/0
0642 176 256 246		8	130	28,0	3	U-4132/0
0642 176 256 261		8	160	28,0	3	U-4132/0
0642 176 256 287		8	200	28,0	3	U-4132/0
0642 176 256 307		10	63	35,3	3	U-4133/0
0642 176 256 322		10	100	35,0	3	U-4133/0
0642 176 256 348		10	130	35,0	3	U-4133/0
0642 176 256 363		10	160	35,0	3	U-4133/0
0642 176 256 389		10	200	35,0	3	U-4133/0
0642 176 256 409		12	63	42,0	3	U-4134/0
0642 176 256 411		12	100	42,0	3	U-4134/0
0642 176 256 424		12	130	42,0	3	U-4134/0
0642 176 256 437		12	160	42,0	3	U-4134/0
0642 176 256 440		12	200	42,0	3	U-4134/0
0642 176 256 452		14	63	44,0	3	U-4134/0
0642 176 256 465		14	100	44,0	3	U-4134/0
0642 176 256 478		14	130	44,0	3	U-4134/0
0642 176 256 480		14	160	44,0	3	U-4134/0
0642 176 256 493		14	200	44,0	3	U-4134/0
0642 176 256 500		16	63	48,0	3	U-4135/0
0642 176 256 513		16	100	48,0	3	U-4135/0
0642 176 256 526		16	130	48,0	3	U-4135/0
0642 176 256 539		16	160	48,0	3	U-4135/0
0642 176 256 541		16	200	48,0	3	U-4135/0
0642 176 256 554		18	63	50,0	3	U-4135/0
0642 176 256 567		18	100	50,0	3	U-4135/0
0642 176 256 570		18	130	50,0	3	U-4135/0
0642 176 256 582		18	160	50,0	3	U-4135/0
0642 176 256 595		18	200	50,0	3	U-4135/0
0642 176 256 602		20	63	52,0	3	U-4136/0
0642 176 256 628		20	100	52,0	3	U-4136/0
0642 176 256 643		20	130	52,0	3	U-4136/0
0642 176 256 669		20	160	52,0	3	U-4136/0
0642 176 256 684		20	200	52,0	3	U-4136/0
0642 176 256 704		25	80	65,0	4	U-4137/0 U-4137/0
0642 176 256 717		25	100	65,0	4	U-4137/0 U-4137/0
0642 176 256 720		25	130	65,0	4	U-4137/0 U-4137/0
0642 176 256 732		25	160	65,0	4	U-4137/0 U-4137/0
0642 176 256 745		25	200	65,0	4	U-4137/0 U-4137/0
0642 176 256 760		32	80	72,0	4	U-4138/0 U-4138/0
0642 176 256 806		32	100	72,0	4	U-4138/0 U-4138/0
0642 176 256 819		32	130	72,0	4	U-4138/0 U-4138/0
0642 176 256 834		32	160	72,0	4	U-4138/0 U-4138/0
0642 176 256 850		32	200	72,0	4	U-4138/0 U-4138/0
0642 176 256 908		40	120	90,0	4	U-5870/0 U-5870/0
0642 176 256 923		40	160	90,0	4	U-5870/0 U-5870/0
0642 176 256 949		40	200	90,0	4	U-5870/0 U-5870/0
0642 176 257 104		50	130	100,0	4	U-4139/0 U-4139/0
0642 176 257 120		50	160	100,0	4	U-4139/0 U-4139/0
0642 176 257 145		50	200	100,0	4	U-4139/0 U-4139/0

Typical order/Sposób zamawiania: 0642 176 257 145 or 7625-50-50-200AD+B

Type 7628



END MILL ADAPTERS TYPE WHISTLE-NOTCH for tools with cylindrical shank and inclined flat DIN 1835-E

OPRAWKI ZACISKOWE TYPU WHISTLE-NOTCH do narzędzi z chwytem walcowym ze spłaszczeniem klinowym DIN 1835-E

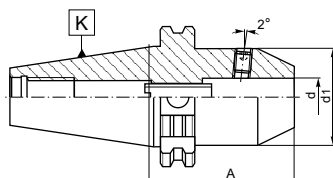

Fig. 1

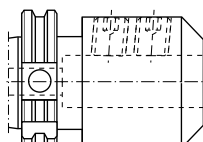
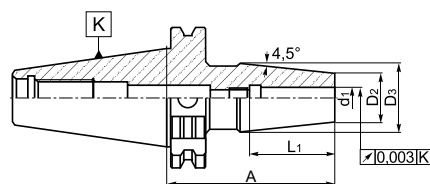

Fig. 2

Type 7630

SHRINK FIT HOLDERS

OPRAWKA FREZARSKA z termicznym mocowaniem narzędzi



Code No / Kod Nr	K	d1	A	L1	D2	D3
0642176300002	40	3	80	36	10	18
0642176301003		3	120	36	10	18
0642176302004		3	160	36	10	18
0642176300030		4	80	36	10	18
0642176301031		4	120	36	10	18
0642176302032		4	160	36	10	18
0642176300069		5	80	36	10	18
0642176301060		5	120	36	10	18
0642176302060		5	160	36	10	18
0642176300104		6	80	36	21	27
0642176301105		6	120	36	21	27
0642176302106		6	160	36	21	27
0642176300160		8	80	36	21	27
0642176301161		8	120	36	21	27
0642176302162		8	160	36	21	27
0642176300206		10	80	42	24	32
0642176301207		10	120	42	24	32
0642176302208		10	160	42	24	32
0642176300250		12	80	47	24	32
0642176301250		12	120	47	24	32
0642176302251		12	160	47	24	32
0642176300288		14	80	47	27	34
0642176301289		14	120	47	27	34
0642176302280		14	160	47	27	34
0642176300308		16	80	50	27	34
0642176301309		16	120	50	27	34
0642176302300		16	160	50	27	34
0642176300336		18	80	50	33	42
0642176301337		18	120	50	33	42
0642176302338		18	160	50	33	42
0642176300351		20	80	52	33	42
0642176301352		20	120	52	33	42
0642176302353		20	160	52	33	42
0642176300400		25	100	58	44	53
0642176301400		25	120	58	44	53
0642176302401		25	160	58	44	53
0642176300453		32	100	58	44	53
0642176301454		32	120	58	44	53
0642176302455		32	160	58	44	53

DIN 69871-AD

Code No / Kod Nr	K 7:24	d	d1	A	Fig.		
0642 176 282 002	40	6	25	50	1	U-4131/0	U-1599/0
0642 176 282 104		8	28	50	1	U-4132/0	U-6317/0
0642 176 282 206		10	35	50	1	U-4133/0	U-0293/0
0642 176 282 308		12	42	50	1	U-4134/0	U-0757/0
0642 176 282 400		14	44	63	1	U-4135/0	U-6318/0
0642 176 282 501		16	44	63	1	U-5887/0	U-6318/0
0642 176 282 603		18	44	63	1	U-5888/0	U-6793/0
0642 176 282 705		20	44	63	1	U-5888/0	U-6793/0
0642 176 282 807		25	65	100	2	U-4137/0 U-4137/0	U-6794/0
0642 176 282 909		32	72	100	2	U-4138/0 U-4138/0	U-6794/0
0642 176 280 601	50	6	25	63	1	U-4131/0	U-1599/0
0642 176 280 703		8	28	63	1	U-4132/0	U-6317/0
0642 176 280 805		10	35	63	1	U-4133/0	U-0293/0
0642 176 280 907		12	42	63	1	U-4134/0	U-0757/0
0642 176 281 001		14	44	63	1	U-4135/0	U-6318/0
0642 176 281 103		16	48	63	1	U-4135/0	U-6318/0
0642 176 281 205		18	50	63	1	U-4136/0	U-6793/0
0642 176 281 307		20	52	63	1	U-4136/0	U-6793/0
0642 176 281 409		25	70	80	2	U-4137/0 U-4137/0	U-6794/0
0642 176 281 500		32	72	100	2	U-4138/0 U-4138/0	U-6794/0
0642 176 281 602		40	90	120	2	U-5870/0 U-5870/0	U-6794/0

Typical order: 0642 176 281 602 or 7628-50-40-120

DIN 69871-AD

Code No / Kod Nr	K	d1	A	L1	D2	D3
0642176300501	50	6	80	36	21	27
0642176301502		6	120	36	21	27
0642176302503		6	160	36	21	27
0642176300555		8	80	36	21	27
0642176301556		8	120	36	21	27
0642176302557		8	160	36	21	27
0642176300603		10	80	42	24	32
0642176301604		10	120	42	24	32
0642176302605		10	160	42	24	32
0642176300657		12	80	47	24	32
0642176301658		12	120	47	24	32
0642176302659		12	160	47	24	32
0642176300685		14	80	47	27	34
0642176301686		14	120	47	27	34
0642176302687		14	160	47	27	34
0642176300705		16	80	50	27	34
0642176301706		16	120	50	27	34
0642176302707		16	160	50	27	34
0642176300733		18	80	50	33	42
0642176301734		18	120	50	33	42
0642176302735		18	160	50	33	42
0642176300759		20	80	52	33	42
0642176301750		20	120	52	33	42
0642176302750		20	160	52	33	42
0642176300807		25	100	58	44	53
0642176301808		25	120	58	44	53
0642176302809		25	160	58	44	53
0642176300850		32	100	58	44	53
0642176301851		32	120	58	44	53
0642176302852		32	160	58	44	53

Typical order/Sposób zamawiania: 0642 176 301 003 or 7630-40-3-120

Type 7655



KEYLESS DRILL CHUCKS with shank

OPRAWKA z uchwytem wiertarskim bezkluczykowym

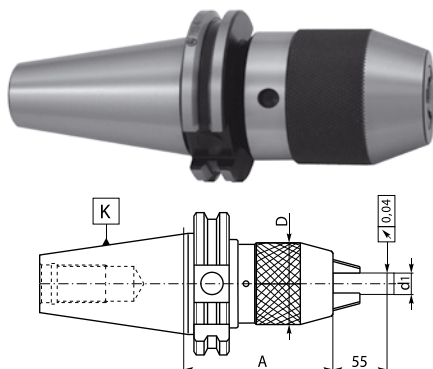

Type 7660



DRILL CHUCKS with exag-key lock system

OPRAWKA z uchwytem wiertarskim kluczykowym

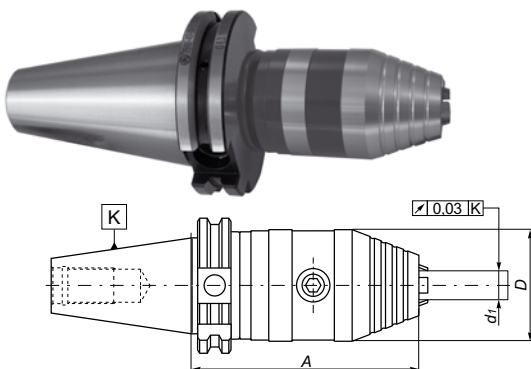

Type 7669



ADAPTERS for screw in type mills

OPRAWKA do frezów wkręcanych

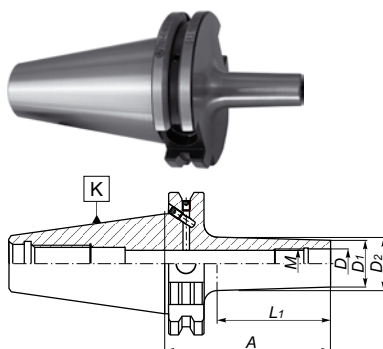

DIN 69871-A

Code No / Kod Nr	K 7:24	d1	A	D
0642 176 550 405	40	1-13	87	50
0642 176 550 446		3-16	106	57
0642 176 550 507	50	1-13	87	50
0642 176 550 548		3-16	90	57

Typical order/Sposób zamawiania: 0642 176 550 548 lub 7655-50-16-90

Standard accessories:
wrench

Wyposażenie podstawowe:
klucz

DIN 69871-AD

Code No / Kod Nr	K 7:24	d1	A	D
0642 176 600 208	40	1-13	105	50
0642 176 600 300		3-16	105	50
0642 176 601 209	50	1-13	105	50
0642 176 601 300		3-16	105	50

Typical order/Sposób zamawiania: 0642 176 600 208 lub 7660-40-13-105

Standard accessories:
wrench

Wyposażenie podstawowe:
klucz

DIN 69871-AD+B

Code No / Kod Nr	K 7:24	M	A	D	D1	D2	L1
0642 176 693 102	40	M8	55	8,5	13	15	30
0642 176 693 204		M8	75	8,5	13	23	50
0642 176 693 306		M8	95	8,5	13	23	70
0642 176 693 408		M8	115	8,5	13	25	90
0642 176 694 103		M10	55	10,5	18	20	30
0642 176 694 205		M10	75	10,5	18	25	50
0642 176 694 307		M10	95	10,5	18	28	70
0642 176 694 409		M10	115	10,5	18	28	90
0642 176 694 500		M10	145	10,5	18	34	120
0642 176 695 104		M12	55	12,5	21	24	30
0642 176 695 206		M12	75	12,5	21	24	50
0642 176 695 308		M12	95	12,5	21	31	70
0642 176 695 400		M12	115	12,5	21	31	90
0642 176 695 501		M12	145	12,5	21	38	120
0642 176 695 603		M12	175	12,5	21	42	153
0642 176 696 105		M16	55	17,0	29	34	30
0642 176 696 207		M16	75	17,0	29	34	50
0642 176 696 309		M16	95	17,0	29	34	70
0642 176 696 400		M16	115	17,0	29	39	90
0642 176 696 502		M16	145	17,0	29	39	120
0642 176 696 604		M16	175	17,0	29	39	153
0642 176 697 106	50	M10	85	10,5	18	28	60
0642 176 697 208		M10	135	10,5	18	28	110
0642 176 697 300		M10	185	10,5	18	32	160
0642 176 698 107		M12	85	12,5	21	32	60
0642 176 698 209		M12	135	12,5	21	32	110
0642 176 698 300		M12	185	12,5	21	36	160
0642 176 699 108		M16	85	17,0	29	36	60
0642 176 699 200		M16	135	17,0	29	40	110
0642 176 699 301		M16	185	17,0	29	42	160

Typical order/Sposób zamawiania: 0642 176 697 106 lub 7669-50-M10-85

Type 9882

DIN 69872-A

PULL STUDS to DIN 69871

KOŃCÓWKI do DIN 69871

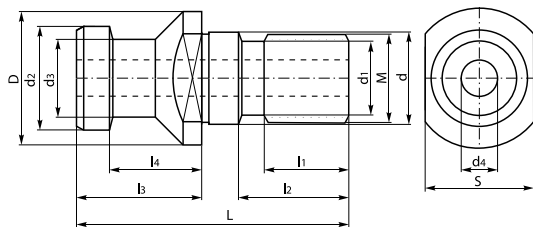

Code No / Kod Nr	Size Wielkość	L	D	d	d1	d2	d3	d4	M	I1	I2	I3	I4	S
0642 198 820 304	30	44	17	13	10,00	13	9	3,00	M12	10	15	24	19	14
0642 198 820 406	40	54	23	17	13,50	19	14	7,00	M16	15	21	26	20	19
0642 198 820 419		85	23	17	8,50	19	14	4,00	M10	10	52	26	20	19
0642 198 820 447		110	23	17	10,00	19	14	5,00	M12	12	77	26	20	19
0642 198 820 421		86	23	17	13,50	19	14	7,00	M16	15	53	26	20	19
0642 198 820 450		111	23	17	13,50	19	14	7,00	M16	15	78	26	20	19
0642 198 820 434		108	23	17	13,50	19	14	7,00	M16	15	75	26	20	19
0642 198 820 600	50	74	36	25	20,00	28	21	11,50	M24	23	30	34	25	30
0642 198 820 653		110	36	25	16,50	28	21	7,00	M20	23	66	34	25	30

Typical order/Sposób zamawiania: 0642 198 820 600 lub 9882-50-74 A

Type 9882

DIN 69872-B

PULL STUDS to DIN 69871

KOŃCÓWKI do DIN 69871

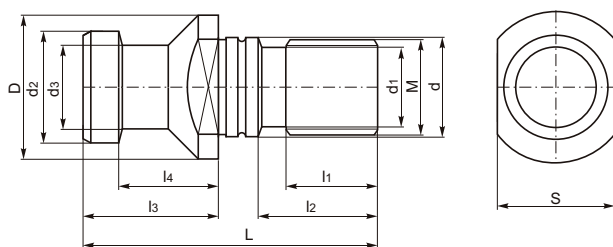

Code No / Kod Nr	Size Wielkość	L	D	d	d1	d2	d3	M	I1	I2	I3	I4	S
0642 198 821 305	30	44	17	13	10,00	13	9	M12	10	15	24	19	14
0642 198 821 407	40	54	23	17	13,50	19	14	M16	15	21	26	20	19
0642 198 821 600	50	74	36	25	20,00	28	21	M24	23	30	34	25	30

Typical order/Sposób zamawiania: 0642 198 821 600 lub 9882-50-74 B